

Salem Village A Ext. 1

Salem Village



SHEET INDEX

- C101 COVER SHEET
- C102 PROJECT NOTES
- C103 FULL DOOR & WINDOW SCHEDULES
- A001 FOUNDATION DIMENSION PLAN
- A002 FOUNDATION ISOMETRIC PLAN
- A101 MAIN LEVEL FLOOR PLAN
- A102 MAIN LEVEL DIMENSION PLAN
- A103 ROOF PLAN
- A201 FRONT & REAR ELEVATIONS
- A202 LEFT & RIGHT ELEVATIONS
- A203 3D VIEWS
- A301 BUILDING SECTIONS 'A', 'B', & 'C'
- A401 ARCHITECTURAL DETAILS
- E101 MAIN LEVEL ELECTRICAL PLAN
- GSN GENERAL STRUCTURAL NOTES
- S0-0 FOOTING & FOUNDATION PLAN
- S1-0 MAIN FLOOR FRAMING PLAN
- S1-1 MAIN FLOOR SHEAR WALL PLAN
- S2-0 ROOF FRAMING PLAN
- SD1 STRUCTURAL DETAILS
- SD2 STRUCTURAL DETAILS

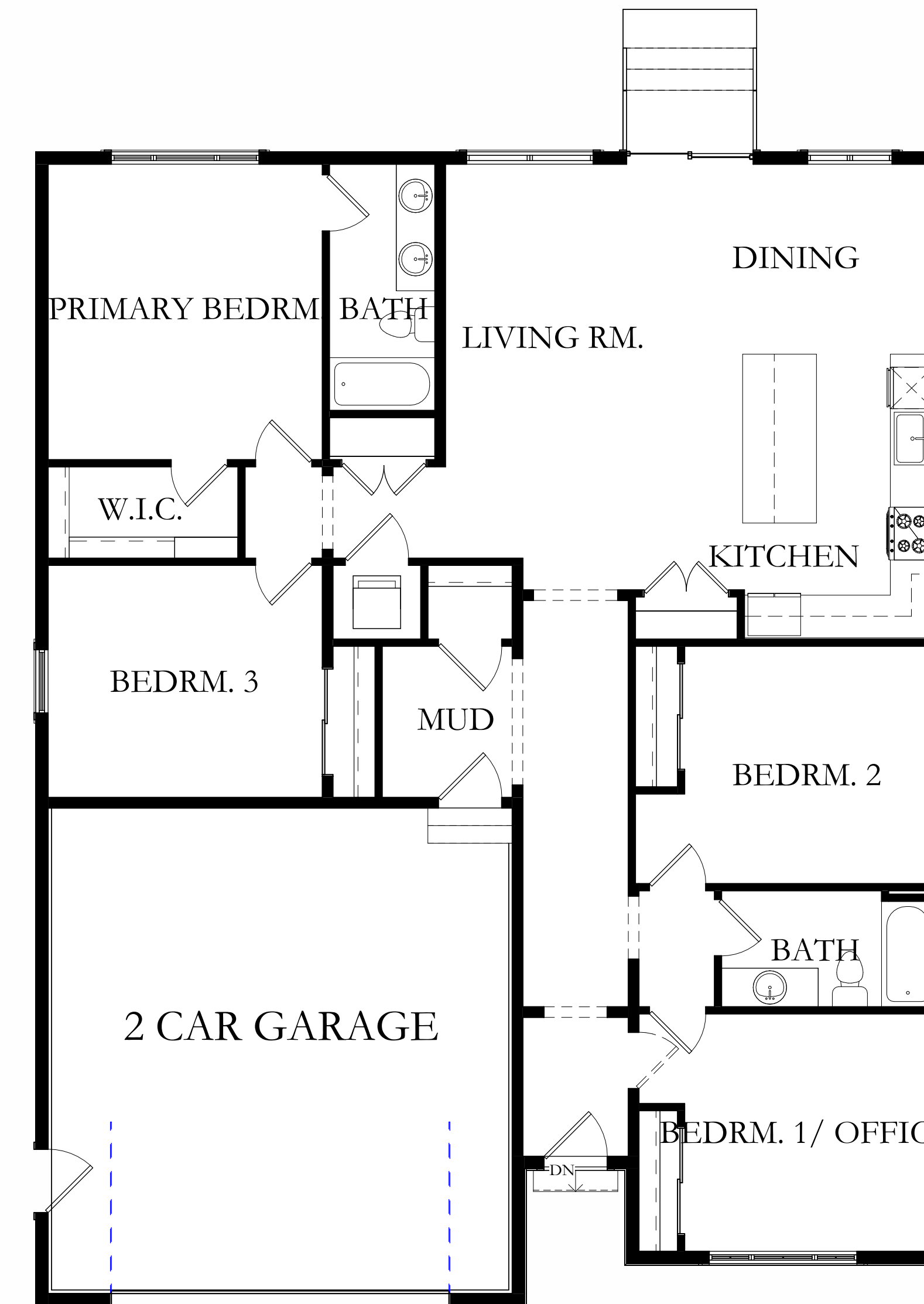

MAIN FLOOR

REVISIONS

1. _____
2. _____
3. _____

Salem Village A Ext. 1

Salem Village
Salem, UT
25 March 2025
Project 22200272941

Builder must confirm all dimensions, site conditions, and measurements prior to construction. Plans and documents are the property of Jewkes Design. Any reuse or distribution in part or in whole without written permission is prohibited.

COVER SHEET

C101

OWNER:

PLAN DESIGNER:

CONTRACTOR:

SQUARE FOOTAGE

Jewkes Design
Nathan Posacki
435-291-1446
Nathan.posacki@jewkesdesign.com

Main Level
Garage Space 532 SF
Living Space 1749 SF
Outdoor Space 213 SF

STRUCTURAL ENGINEER:

Arches Engineering
Eric Scott
801-642-4897
office@archesengineering.com